

CARSON

DR-300 ezRead Electronic Reading Aid

I) Installing the batteries

- Remove the battery door.
- Install 3 AAA alkaline batteries with the correct polarity.
- Attach the battery door.

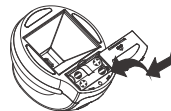

II) Using the power adaptor (alternative power source)

- Plug the small end of the USB cable into the micro USB port on the device.
- Plug the other end of the USB cable into the power adaptor.
- Plug the power adaptor into a power outlet.

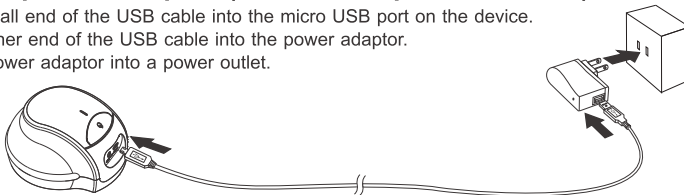

III) Connecting the device to a television set

- Ensure the television is on video mode. Change mode by pressing "Input" or "TV/Video" button on television remote.
- Connect the device to a television using a video cable.

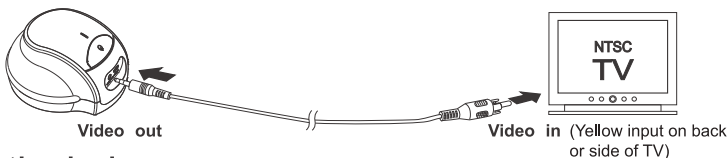

IV) Using the device

i. To turn on the device

Press and hold down the power button for 2 seconds.



The LED indicator will turn green when the device is turned on.



ii. To turn off the device

Press and hold down the power button for 2 seconds.

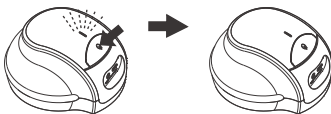

iii. Low battery indicator

When the battery level is low, the LED indicator light will turn red during use.

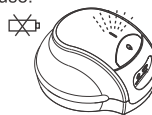

Note: The device will turn off automatically after 15 minutes from pressing the power button.

V) Specifications

- Magnification: 13.5x on a 32" TV
- Viewing area: 47mm x 35mm
- Illumination: LED
- Resolution: VGA
- Interface: TV (NTSC)
- Power: 3 x AAA alkaline batteries (not included) or USB

VI) Care and safety information

- Remove the batteries before storing the device for an extended period.
- Do not recharge non-rechargeable batteries.
- Do not mix new and old batteries.
- Do not mix alkaline, carbon-zinc or rechargeable (nickel-cadmium) batteries.

WARNING: To avoid possible permanent eye damage, do not place lighted Digital Reader directly upon human eye.